

Since macOS High Sierra 10.13, the operating system applies a stricter security policy to software that requires kernel extensions (kexts). The SMI driver installation includes a system extension (SmiIOFbDriver.kext) that is affected by this policy.

As a result, the user now has to explicitly enable this system extension in the Security & Privacy system preference after installation and before the SMI software is allowed to run.

HOW TO CHECK IF THE SMI KEXT IS BLOCKED

You can check if the SMI Kext is blocked by opening the System Report (Apple menu -> About) and select Extensions on the left pane and look for SmiIOFbDriver..kext. Check the "Loaded" column. See the screenshot below, which shows the Kext blocked.

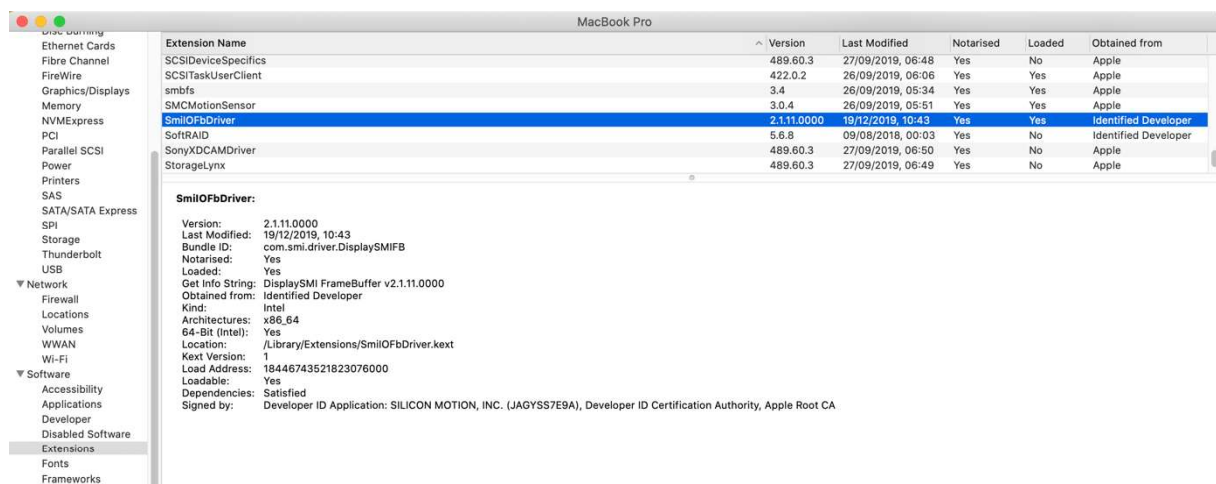

Extension Name	Version	Last Modified	Notarised	Loaded	Obtained from
SCSISDeviceSpecifics	489.60.3	27/09/2019, 06:48	Yes	No	Apple
SCSITaskUserClient	422.0.2	26/09/2019, 06:06	Yes	Yes	Apple
smbfs	3.4	26/09/2019, 05:34	Yes	Yes	Apple
SMCMotionSensor	3.0.4	26/09/2019, 05:51	Yes	Yes	Apple
SmiIOFbDriver	2.1.11.0000	19/12/2019, 10:43	Yes	No	Identified Developer
SoftRAID	5.6.8	09/08/2018, 00:03	Yes	No	Identified Developer
SonyXDCAMDriver	489.60.3	27/09/2019, 06:50	Yes	No	Apple
StorageLynx	489.60.3	27/09/2019, 06:49	Yes	No	Apple

SmiIOFbDriver:	
Version:	2.1.11.0000
Last Modified:	19/12/2019, 10:43
Bundle ID:	com.smi.driver.DisplaySMIFB
Notarised:	Yes
Loaded:	Yes
Get Info String:	DisplaySMI FrameBuffer v2.1.11.0000
Obtained from:	Identified Developer
Kind:	Intel
Architectures:	x86_64
64-Bit (Intel):	Yes
Location:	/Library/Extensions/SmiIOFbDriver.kext
Kext Version:	1
Load Address:	18446743521823076000
Loadable:	Yes
Dependencies:	Satisfied
Signed by:	Developer ID Application: SILICON MOTION, INC. (JAGYSS7E9A), Developer ID Certification Authority, Apple Root CA

If this is set to "No" then the kext is blocked and needs to be enabled following the steps below.

ENABLING THE SMI KEXT

Please note: It's only possible to enable the system extension in the 30 minutes following the installation. A new installation can be run to reset this timer.

At the end of the installation, the operating system should display a "System Extension Blocked after installation" warning and ask the user to enable the SMI extension

(Figure 1)

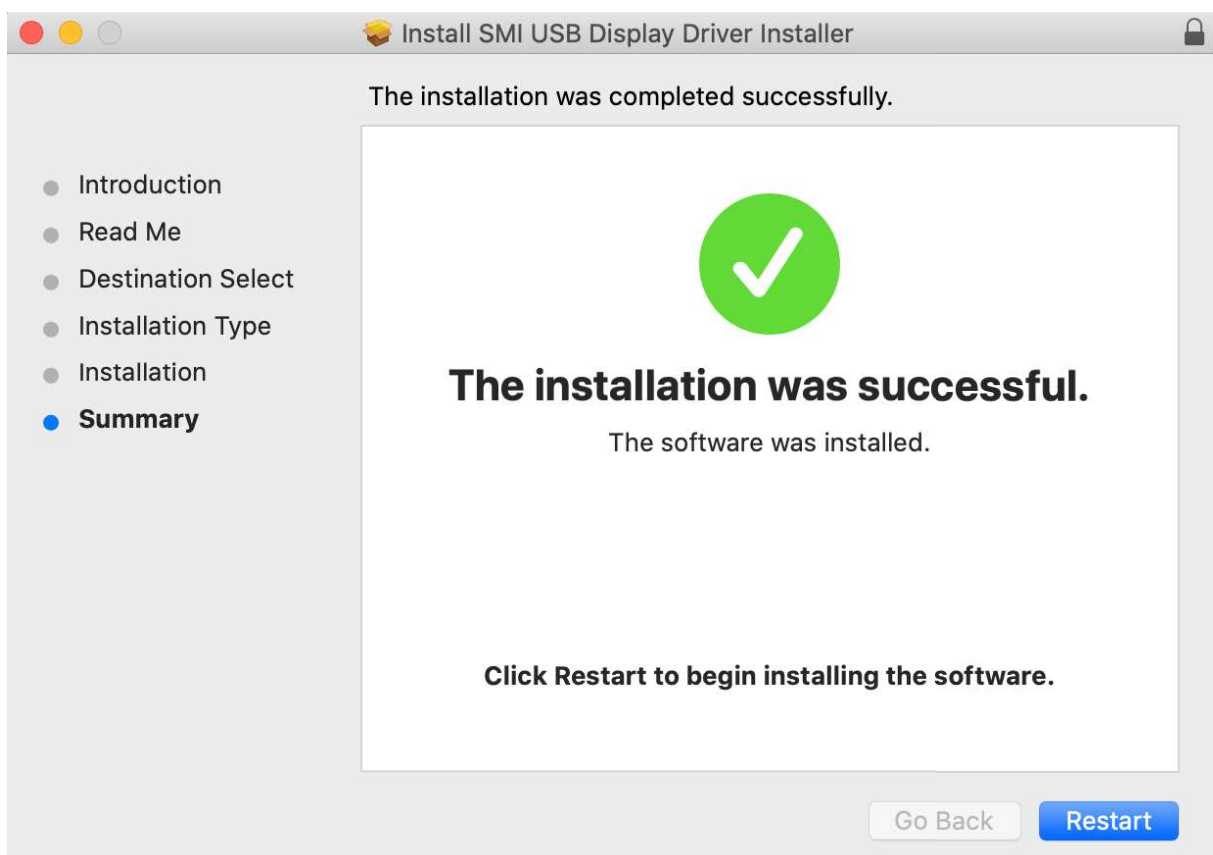
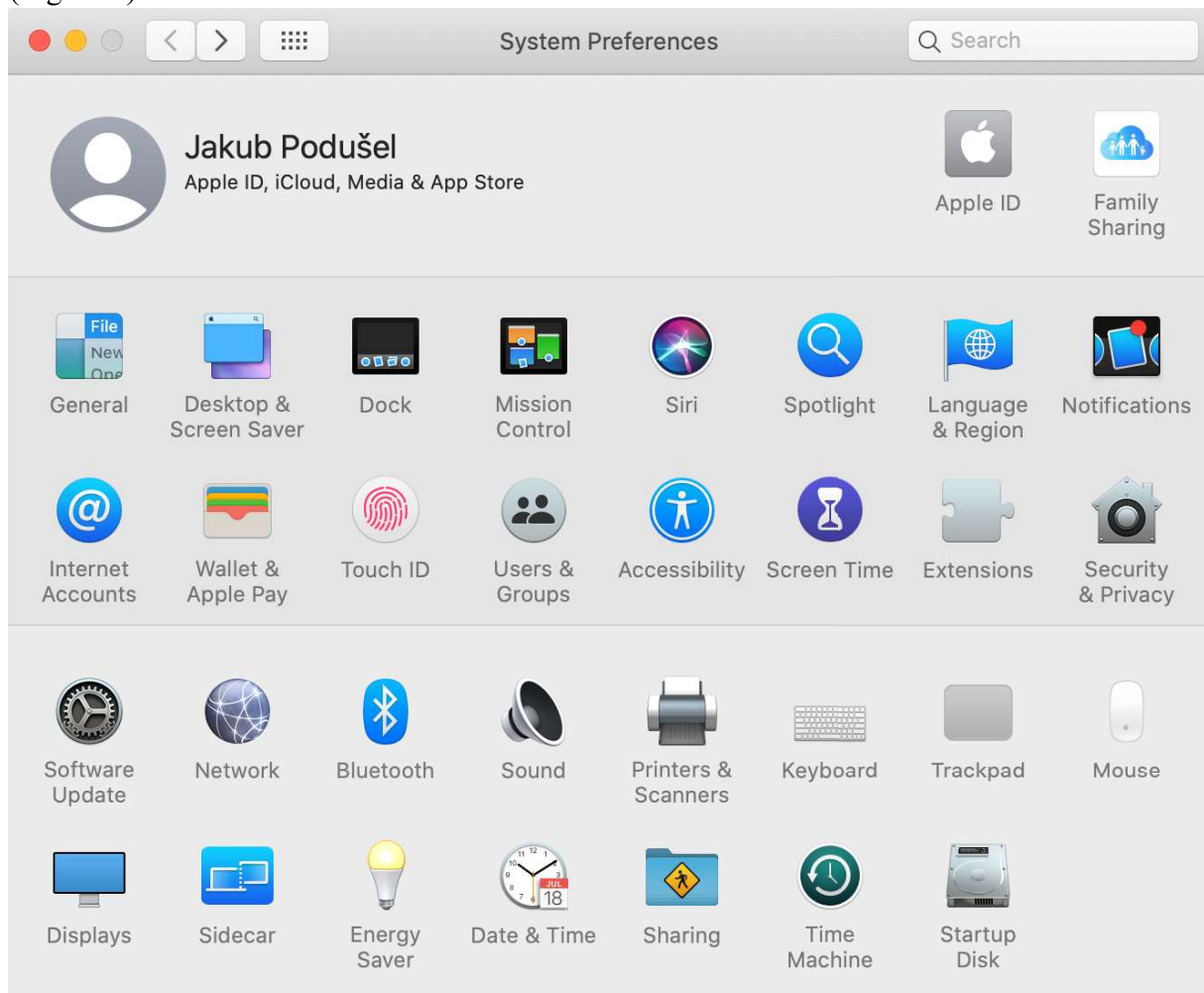

Figure 1

Important: This warning is not always shown. Even if it is not shown, for new installations the user must enable the kernel extension to use the SMI product.

The setting is available by choosing System Preferences from the Apple Menu and then clicking on the Security & Privacy panel (*Figure 2*).

(Figure 2)



Follow *Figure 3 - Figure 5* to enable the SMI Software to run on the system. Please note that the interface presented may be different if multiple software require user authorisation.

(Figure 3) Click on the lock in left corner and put in your credentials

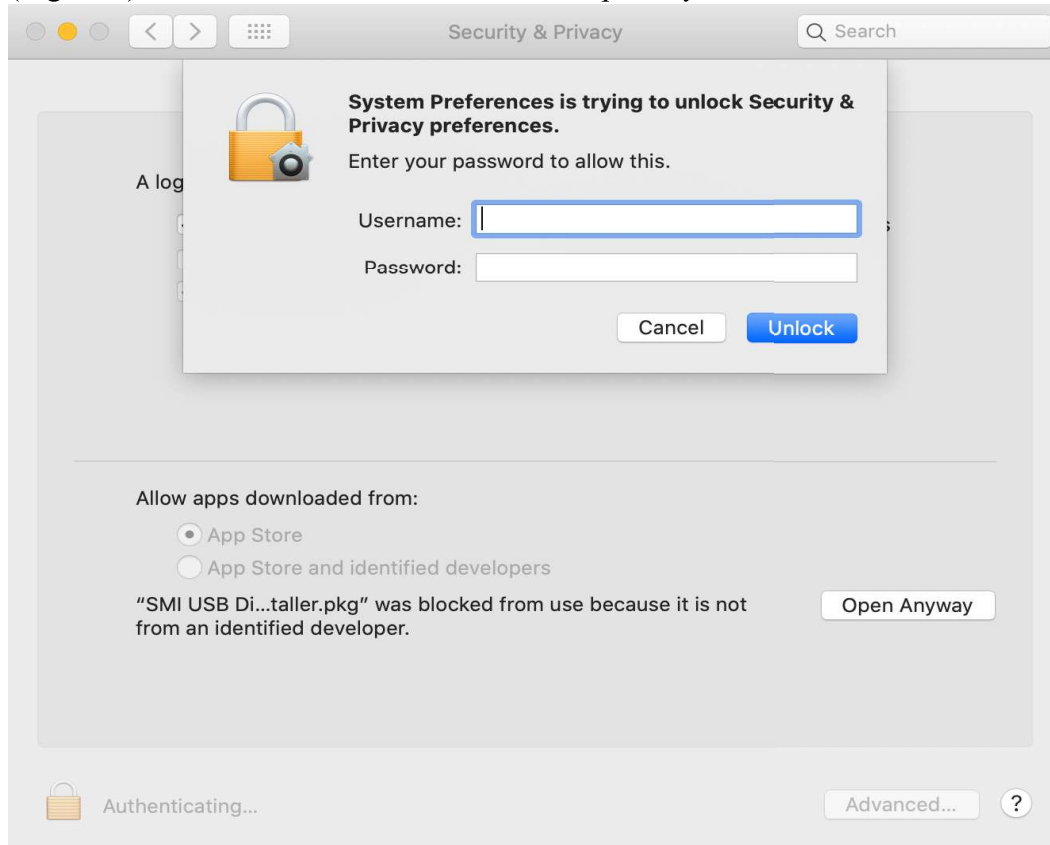

(Figure 4) Click on Allow

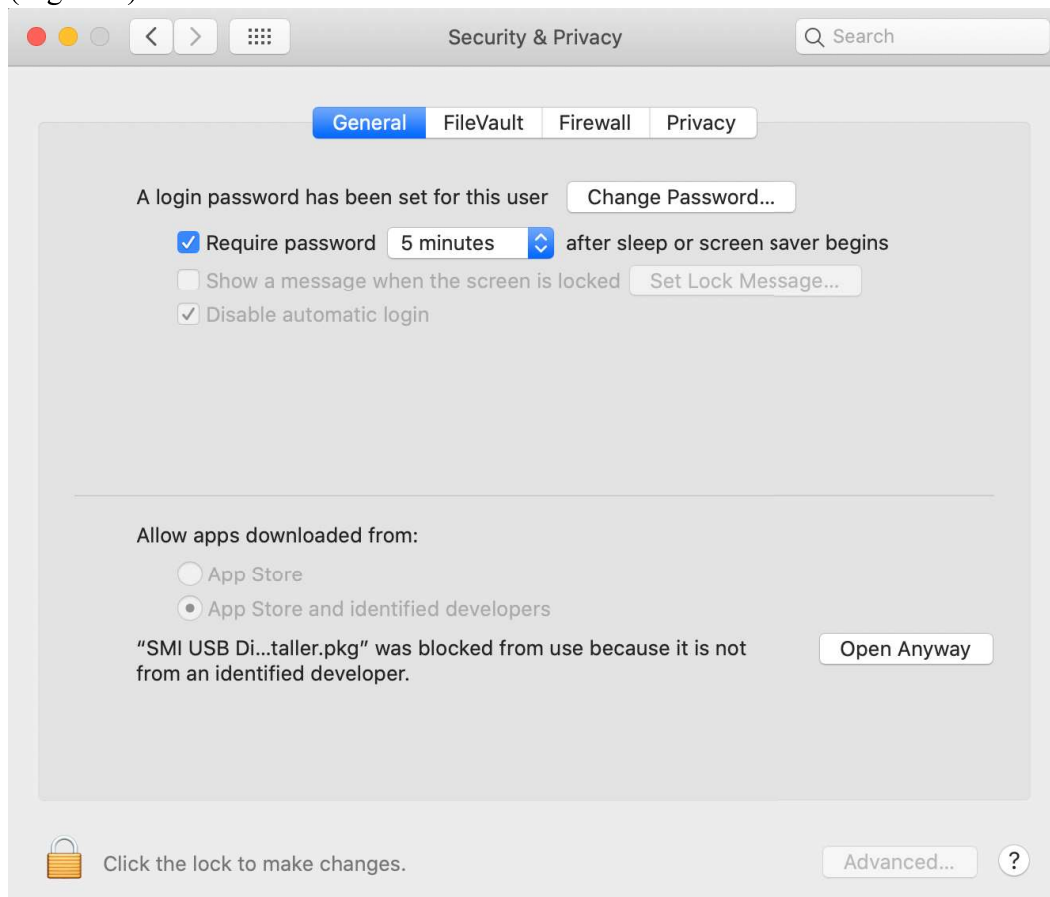

(Figure 5) Click on Restart

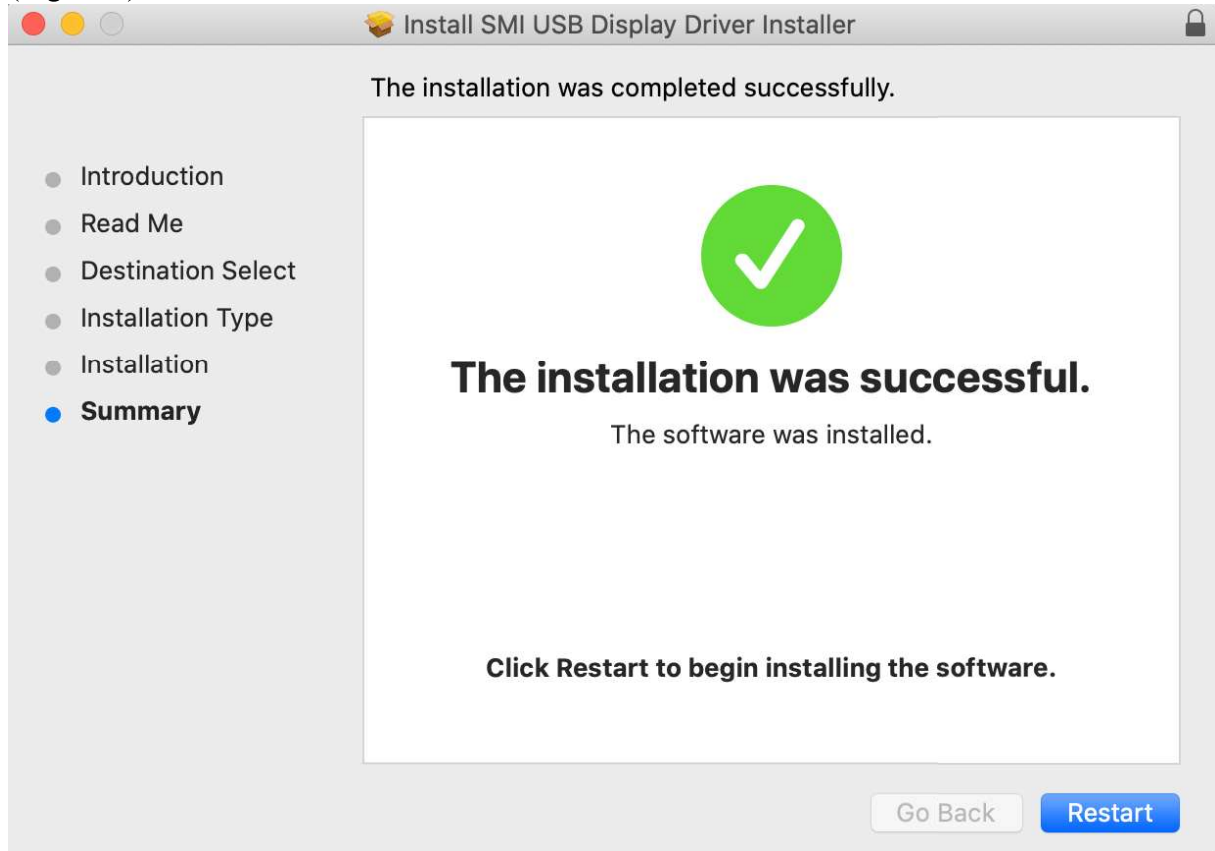

Occasionally popup from *Figure 1* may not be displayed and after the installation and reboot the SMI additional monitors might not be functional. To resolve this it is required to manually allow the SMI driver to be loaded on system following *Figure 2 – Figure 4* and reboot the system at the end.